

NOT TO SCALE  
December 7, 2016

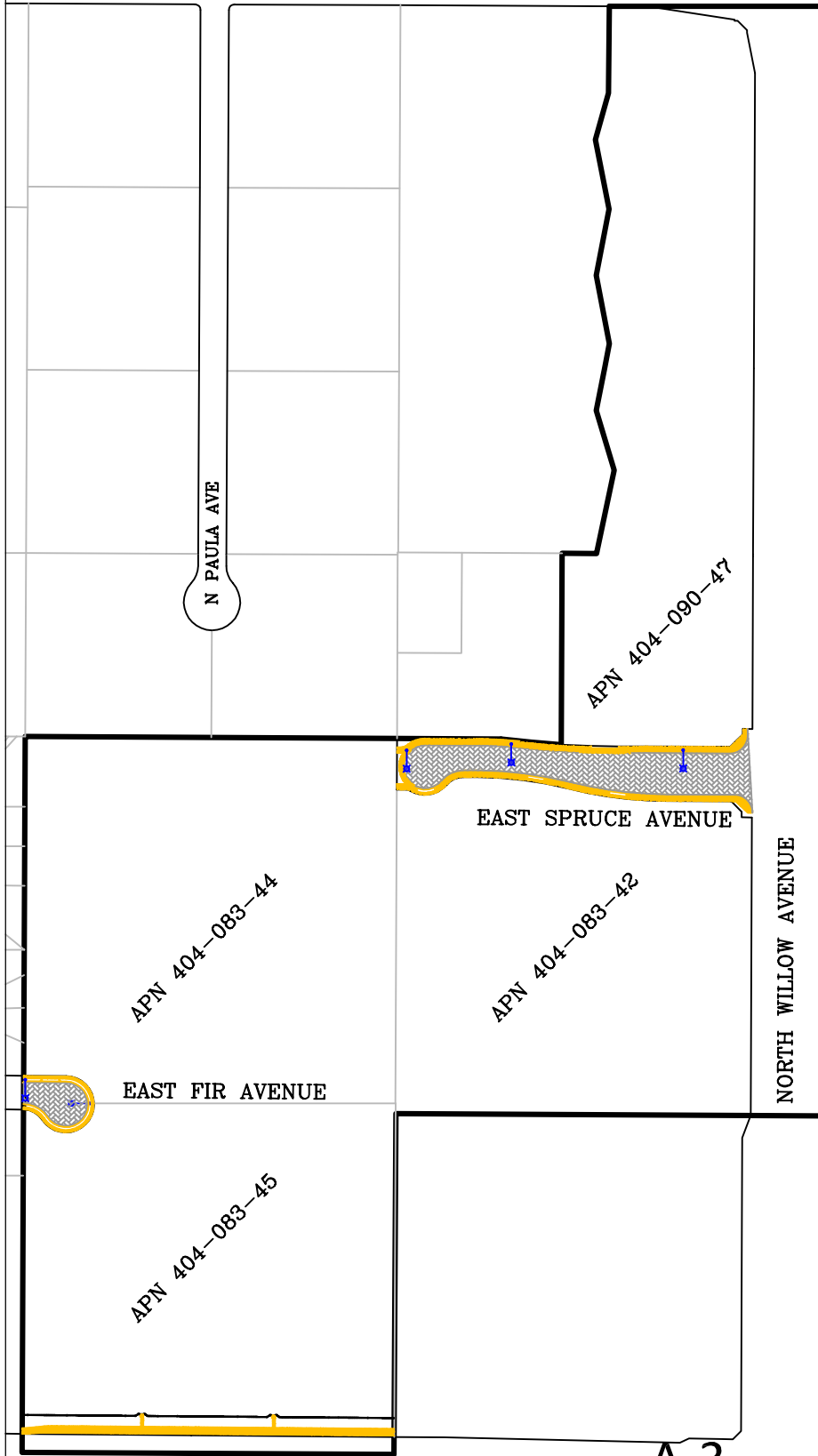

**EAST SPRUCE AVENUE**



CONCRETE IMPROVEMENTS:  
CURB & GUTTER = 1,170 LF  
CURB ONLY = 102 LF  
VALLEY GUTTER = 1,012 SF  
SIDEWALK/CURB RAMPS = 11,359 SF



INTERIOR PAVEMENT:  
TOTAL AREA = 37,508 SF

3 LED STREET LIGHTS



**EAST FIR AVENUE**

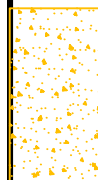

CONCRETE IMPROVEMENTS:  
CURB & GUTTER = 289 LF  
SIDEWALK = 1,252 SF



LOCAL STREET PAVING:  
TOTAL AREA = 6,368 SF

1 LED STREET LIGHT



**EAST HERNDON AVENUE**



CONCRETE IMPROVEMENTS:  
TRAIL & WALKS = 8,042 SF

EAST HERNDON AVENUE

A-3