

State of California — The Resources Agency
DEPARTMENT OF PARKS AND RECREATION
PRIMARY RECORD

Primary # _____
HRI # _____
Trinomial _____
NRHP Status Code 5

Other Listings _____
Review Code _____ Reviewer _____ Date _____

Page 1 of 2 *Resource Name or #: (Assigned by recorder) None

P1. Other Identifier Holland Woods Residence

* P2. Location: Not for Publication Unrestricted *a. County Fresno

(P2b and P2c or P2d. Attach a Location Map as necessary.)

*b. USGS 7.5' Quad _____ Date _____ T _____; R _____; 1/4 of 1/4 of Sec _____; B.M.

c. Address 567 East Clinton Avenue City Fresno Zip 93704

d. UTM: (Give more than one for large and/or linear resources) Zone _____; _____ mE/ _____ mN

e. Other Locational Data: (e.g., parcel #, directions to resource, elevation, etc., as appropriate) APN: 443-314-22

* P3a. Description: (Describe resource and its major elements. Include design, materials, condition, alterations, size, setting, and boundaries)

The Wild Residence is located approximately 3 and 1/2 miles Northwest of the Fresno County Court house. It is located on the North side of East Clinton Avenue between North Van Ness Boulevard and North Wilson Avenue in Fresno's Tower District. Located in the proposed Terrace Gardens Historic District this two-story detached single family residence is a basic rectangular plan measuring approximately 31 feet in depth (north to south) by 60 feet in width (east to west). According to the original floor plans the living area of the residence measures 3,424 square feet. There are 5 bedrooms, 2 and 1/2 baths, entrance hall, library, living room, dining room, butlers pantry, kitchen, breakfast nook, laundry porch, full basement and a semi-finished large attic. This English Tudor house is of wood frame construction with brick veneer covering approximately 60% of the exterior vertical surfaces. The exterior brick is laid in a running bond pattern and is a combination of clinker with dark grout and tooled joints and common brick with light grout that is flush with the face of the brick. The common brick areas have a color wash over both the grout and brick surfaces that evens out the color of the wall surface making it appear more monolithic. The two brick finishes are stepped together throughout the façade in a rather random pattern. The upper wall areas are a combination of half-timbered and modeled plaster panels. The plaster areas appear to be hand colored to emphasize the rough texture. The gable end areas are horizontal lapped wood siding finished with a dark stain. The roof is a steeply sloped side gable with a large cross gable. (see continuation sheet 2 of 2)

*P3b. Resource Attributes: (List attributes and codes) HP2 - single family property

*P4. Resources Present: Building Structure Object Site District Element of District Other (isolates, etc.)



P5b. Description of Photo: (View, date, accession #) South and west elevation, 13 Oct 1999

*P6. Date Constructed/Age and

Sources: Historic Both
 Prehistoric

Constructed in 1929.

The residence is 70 years old.

Source: City of Fresno Building permits

*P7. Owner and Address:

Adams Holland & Tim Woods

567 E. Clinton Ave.

Fresno, CA 93704

*P8. Recorded by: (Name, affiliation, and address)

Chris Johnson

Johnson Architecture

942 E. Olive Ave., Fresno, CA 93728

*P9. Date Recorded: 14 October 1999

*P10. Survey Type: (Describe)

Intensive

*P11. Report Citation: (Cite survey report and other sources, or enter "none.") North Van Ness Boulevard Survey

*Attachments: Location Map Sketch Map Continuation Sheet Building, Structure, and Object Record

Archaeological Record District Record Linear Feature Record Milling Station Record Rock Art Record

Artifact Record Photograph Record Other (List) Copies of original Floor Plans

PRIMARY RECORD - CONTINUATION SHEET

Page 2 of 2

- P3a. Description: (continued)

There are two shed dormers in the roofs. One is located at the second floor west side of the house and one up at the attic area on the north side. They are covered with a shingle roof and horizontal wood siding with a dark stain. The cross gable end vergeboards have a wavy lower edge detail. The roofs are covered in a heavy shake shingles in a staggered pattern. The front entry extends from the main building to the south and has a clinker brick structure supporting a half timbered gable end. The entry porch floor surface is made of brick. The porch crossbeam has a scalloped detail on the underside. The front door is an arched top solid wood door with a wrought iron dragon fly doorknocker. Other exterior doors are a "French" type with wood frames and true divided lites. There are 10 glass panes in each door. A sweeping eave extends out to the west to cover a scored concrete porch area adjacent to the living room. A brick bay window extends out from the dining room with a hipped shingle roof. The corners of the bay are detailed with uncut full end bricks overlapped and interlocked to form a unique detail. There is a small stick framed porch cover with a shingled roof at the north side exit from the laundry porch. The windows are steel sash casement throughout. Most of the windows are of 8 or 12 panes. The glass appears to be very flat and true without any noticeable waves. There are two fixed pane windows in the laundry area at the rear porch. The library window on the south side has a pair of fixed shutters. This is the only window to have shutters in the residence. There are ghost lines of what appear to window planter boxes on the south façade. There is one large fireplace located on the west end of the residence. It extends from the porch through the roof area and is finished in clinker brick. There is a small shingle cricket roof on the east side of the chimney. There is another brick stack that is internal and extends through the roof near the north center of the house. This stack is used as an exhaust flue for the basement water heater. The site also contains an independent three-car garage structure. The garage is covered in horizontal dark stained wood siding similar to the gable ends on the residence. There are large sliding doors over two of the garage spaces. The third space, located on the west end, is clearly a later addition to the building. The garage is currently used as storage.

State of California — The Resources Agency
 DEPARTMENT OF PARKS AND RECREATION
 BUILDING, STRUCTURE, AND OBJECT RECORD

Primary # _____
 HRI # _____

Page 1 of 2

NRHP Status Code 5

*Resource Name or #: (Assigned by recorder) None

B1. Historic Name: Wild Residence

B2. Common Name: Holland /Woods Residence

B3. Original Use: Private Residence B4. Present Use: Private Residence

* B5. Architectural Style: Tudor

* B6. Construction History: (Construction date, alterations, and date of alterations)

Building Permit No. 7975 Issued 1 June 1929
 Certificate Of Occupancy No.259 Issued 18 October 1929
 Addition to garage No. 9683 Issued 14 October 1938

* B7. Moved? No Yes Unknown Date: _____ Original Location: _____

* B8. Related Features:

A detached carriage house, used as a garage sits on the northwest corner of the property
 A brick bar-b-que sits near the northeast corner of the property

B9a. Architect: Orville R. Taylor (attrib.) & Doris. Wild b. Builder: Taylor -Wheeler Construction

* B10. Significance: Theme Residential Architecture Area City of Fresno

Period of Significance 1929 Property Type Residence Applicable Criteria N/A

(Discuss importance in terms of historical or architectural context as defined by theme, period, and geographic scope. Also address integrity.)

The Wild Residence was first occupied in 1929 by Mount K. Wild (1890-1959) and his spouse, Doris Ludlow Wild (1890-1986). The Wilds selected a double lot just west of North Van Ness Boulevard for their home. The property was farmland at the time. The residence cost \$13,000 to construct and was completed just prior to the stock market crash of 1929. Mount K. Wild was born in Hamilton Ontario, Canada. His parents moved to Indianapolis, Indiana, when he was four. It was there where he completed his early education. In 1912 he graduated from Yale University with a Bachelor of Arts degree. His career in law began in 1914 when he joined the Fresno Law Firm of Everts and Ewing. He later became the founder of the Wild, Christensen, Barnard and Wild Law firm, Fresno's oldest continuing law firm. His firm still continues today under the name of Wild Carter & Tipton. Wild completed his doctorate at the University of California and became one of the few lawyers in the San Joaquin Valley to hold a doctorate of law degree. Wild was a member of the Fresno County, California State and American Bar Associations. A 33rd degree Mason, he was a past master of the (see continuation sheet 2 of 2)

B11.Attributes: Additional Resource (List attributes and codes) HP2- single family property

* B12. References: Fresno Parcel Maps. Sanborn Insurance Maps. Building Permit (#7975). Fresno City Polk Directory, 1929-99. FMR (9-25-1929). FB (12-10-59, p. 22-A). FB (10-22-86, p. D12). FB (5-22-88, p. E1 & E4). Fresno Office of the Assessor (10-12-99) (see continuation sheet 2 of 2)

B13. Remarks: None

* B14. Evaluation: Chris Johnson, Johnson Architecture.
942 E. Olive Ave. Fresno, CA 93728

* Date of Evaluation: 14 October 1999

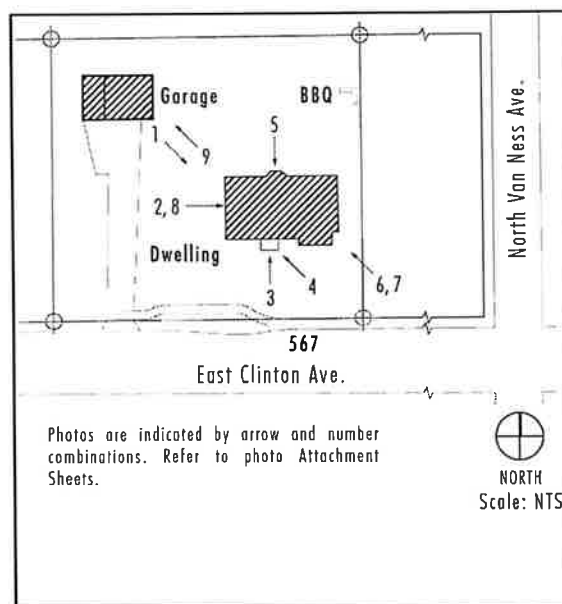
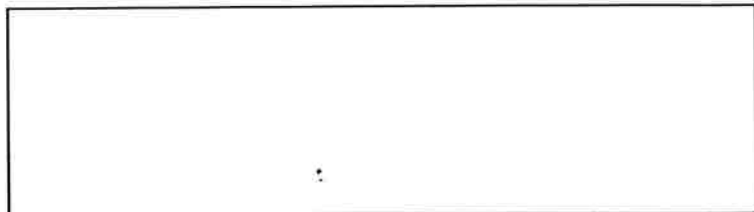

BUILDING, STRUCTURE, AND OBJECT RECORD - CONTINUATION SHEET

Page 2 of 2

* B10. Significance: (continued)

Fresno Lodge of Perfection, Fresno Consistory, a knight commander of the Court of Honor and a former deacon of the Fresno Council of Kadosh, all Masonic organizations. Wild had been president of the Fresno Rotary Club and the Sequoia Council, Boy Scouts of America. He was also a director of the University-Sequoia Sunnyside Club. At the time of his death in 1959, Wild had been a former Fresno County Bar Association president and a long time Fresno attorney. Mount K. Wild was the attorney for the builders Taylor and Wheeler, who subdivided the area around the Clinton and Van Ness area and built the Wild Residence. Taylor Wheeler produced some of the valleys finest homes over the 40-year span of their business. Their homes are highly sought after today for the high level of design and historical value. Doris Ludlow Wild graduated from the University of Ohio. Doris had been a schoolteacher in Ohio before coming to Fresno in 1915. She was a charter member of the Fresno branch of the American Association of University Women, a Golden Arrow member of the Pi Beta Phi sorority and an early member of the Fresno Garden Club. They had two children M. Gordon and Janet Wild. Both of the children preceded their mother in death. She lived in the house from 1929 until her death at age 94 in 1996. Doris worked closely with Taylor-Wheeler in the design of the home and personally oversaw the construction of the home. Protecting the design integrity and assuring a high level of detail, craftsmanship and overall quality. Prior to constructing this home Doris had designed several homes in the Fresno area and on the Central Coast of California. This was unusual for a woman during this period of time. The Wild Residence is architecturally important as an outstanding example of the English Tudor style of architecture. The quality of design and craftsmanship is completed at a very high level. The plan is spacious and well thought out. Finely detailed and one, if not the, best example of this style remaining in the Fresno Area. The home contributes to the proposed Terrace Gardens Historic District and was determined in the Tower District Specific Plan of 1991 to be a "Primary Resource" for the Tower District. One of only two properties identified within the proposed Terrace Gardens Historic District as such a resource. The residence's period of significance is limited to the date of construction due to the fact that Mr. Wild's date of retirement (productive years) could not be determined from research. Significant under National Register criteria 'B' and 'C', the property represents a type (early subdivision housing), period (post World War I), and method of construction (wood frame) and shows structural and material integrity. It has architectural distinction and is the work of a master builder. It is also associated with a prominent and important local attorney and a female designer of great ability.

B12. References: (continued)

Fresno Death Records, Book No. 61, Page 265. Book No. 3776. Book No. 23, Page 360. Book No. 43, Page 356. Book No. 94 Page 750. The Historical Significance of Fresno's North Van Ness Boulevard, (5-8-85). A Field Guide To American House, (pp. 354-71). Historic Building Survey, Ratkovich Plan, Fresno, CA. Tower District Specific Plan, Fresno, CA (3-26-1991, pp.3-20,21).