

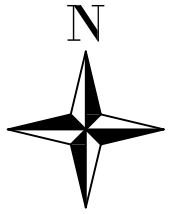

PUBLIC WORKS DEPARTMENT
TRAFFIC AND ENGINEERING SERVICES DIVISION
FEATURES TO BE ADDED BY ANNEXATION NO. 79
COMMUNITY FACILITIES DISTRICT NO. 11



NOT TO SCALE
February 24, 2017

FINAL TRACT MAP NO. 6091
"NO PHASES"

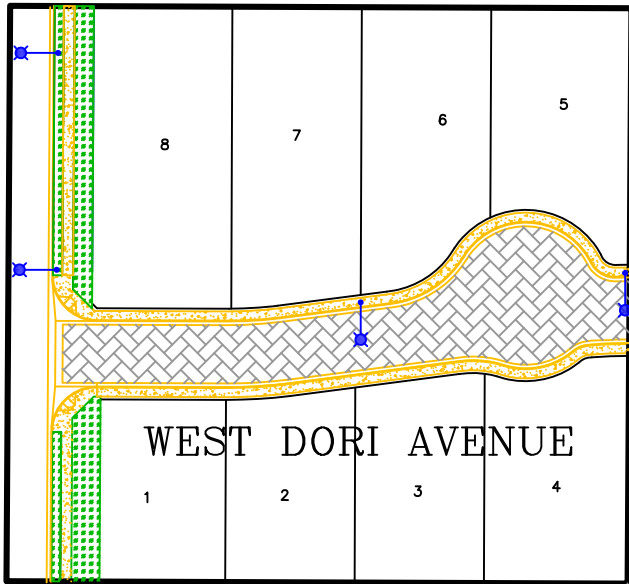

LANDSCAPE AND IRRIGATION:

TREES & SHRUBS = 4,341 SF

LARGE TREES = 6 EA

SMALL TREES = 5 EA



CONCRETE IMPROVEMENTS:

CURB & GUTTER = 924 LF

VALLEY GUTTER = 539 SF

SIDEWALK & CURB RAMPS = 5,017 SF



STREET LIGHTS:

TOTAL = 4 EACH



INTERIOR PAVEMENT:

TOTAL AREA = 12,564 SF

NORTH CORNELIA AVENUE

WEST DORI AVENUE

WEST MCKINLEY AVENUE