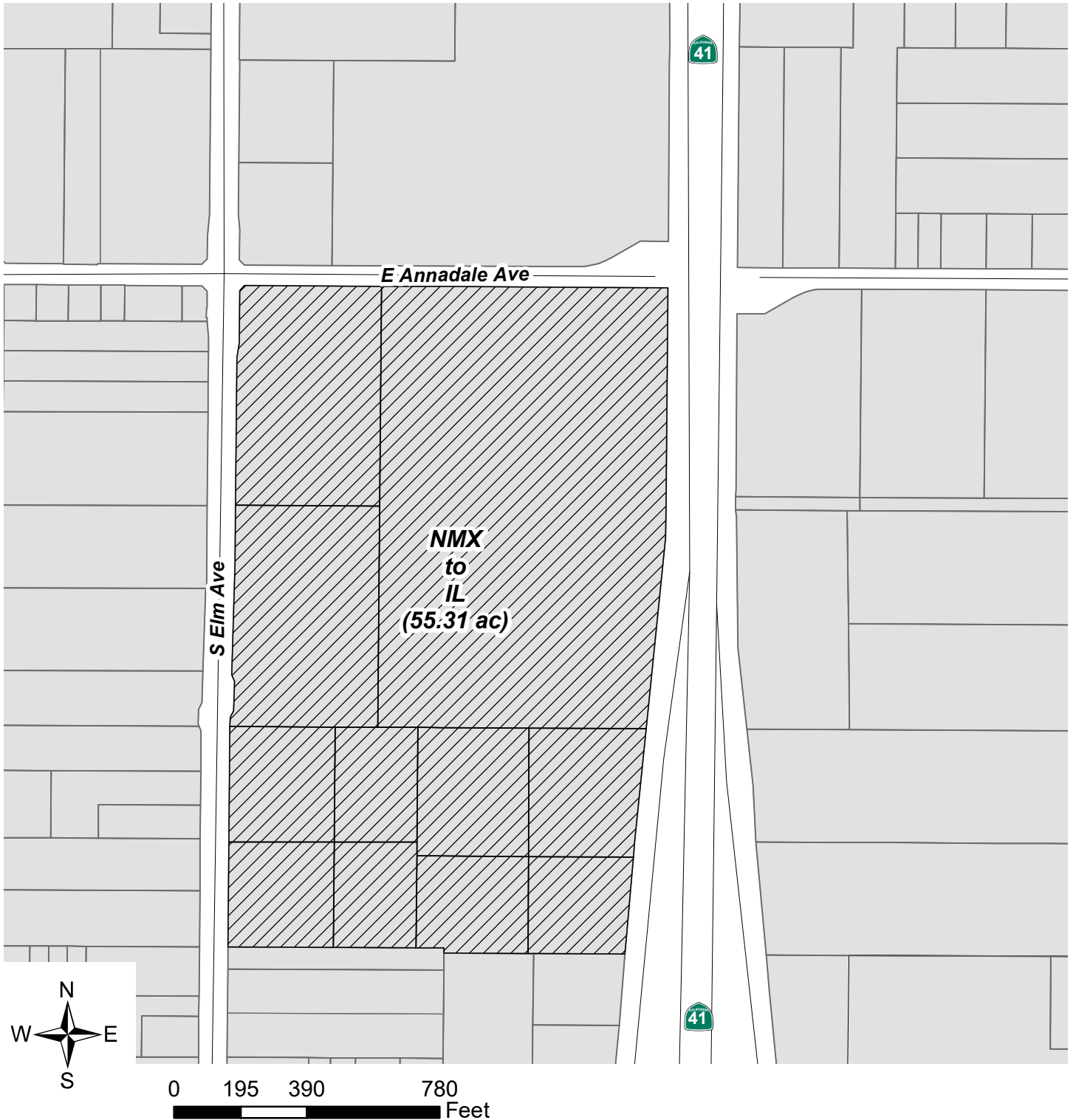

Exhibit E

Proposed Rezone Exhibit



APNs: (328-290-29, 328-290-25, 328-211-43, 328-211-50, 328-211-44, 328-211-49, 328-211-45, 328-211-48, 328-211-46, 328-211-47, 328-290-28)

Southeast Corner of S Elm Ave and E Annadale Ave Intersection.

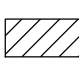
 Proposes to rezone from NMX (Neighborhood Mixed Use) to IL (Light Industrial) zoning district.