



ASSESSOR'S PARCEL NO. 511-250-02

PUBLIC WORKS DEPARTMENT
LAND PLANNING & SUBDIVISION INSPECTION SECTION
FEATURES TO BE ADDED BY ANNEXATION NO. 63
COMMUNITY FACILITIES DISTRICT NO. 9



NOT TO SCALE
August 21, 2024

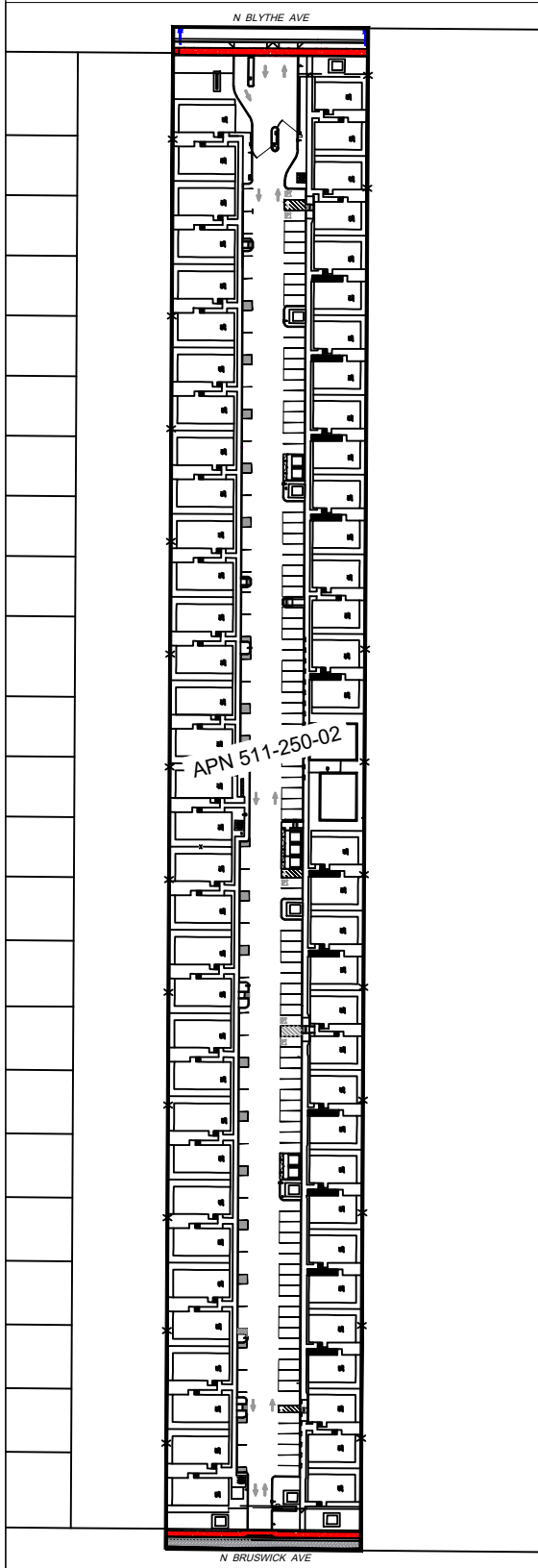

CONCRETE IMPROVEMENTS:

 SIDEWALK = 1,830 SF
CURB & GUTTER = 330 LF

LANDSCAPE AND IRRIGATION:

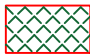
 LANDSCAPE AND IRRIGATION WITHIN
PUBLIC RIGHT-OF-WAY TO BE
MAINTAINED BY PROPERTY OWNER

STREET LIGHTS:

 TOTAL = 2 EACH

LOCAL STREET PAVEMENT:

 INTERIOR RESIDENTIAL = 1,030 SF

N BLYTHE AVE

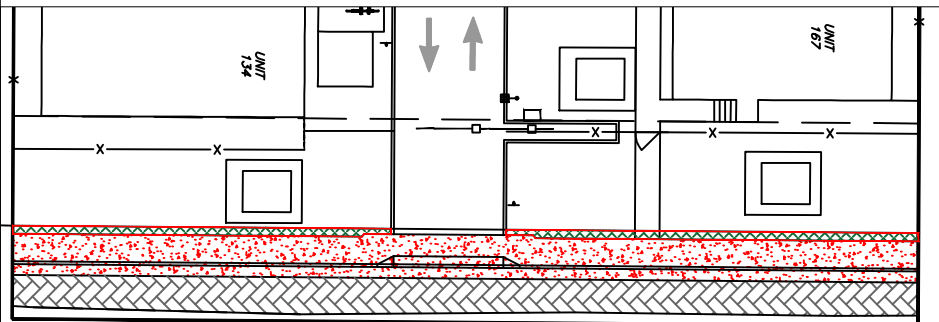
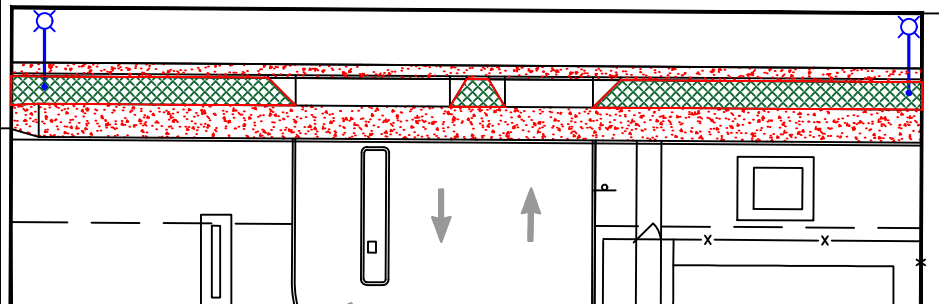

N BRUSWICK AVE