

NOT TO SCALE  
March 8, 2016

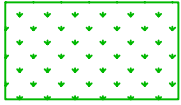

LANDSCAPE AND IRRIGATION:

BUFFERS/PARKWAYS (TREES & SHRUBS) = 7,056 SF

LARGE TREES = 14 EA

SMALL TREES = 6 EA



CONCRETE IMPROVEMENTS:

CURB & GUTTER = 9,141 LF

VALLEY GUTTER = 2,234 SF

SIDEWALK & CURB RAMPS = 49,136 SF

SOUTH ARMSTRONG AVENUE

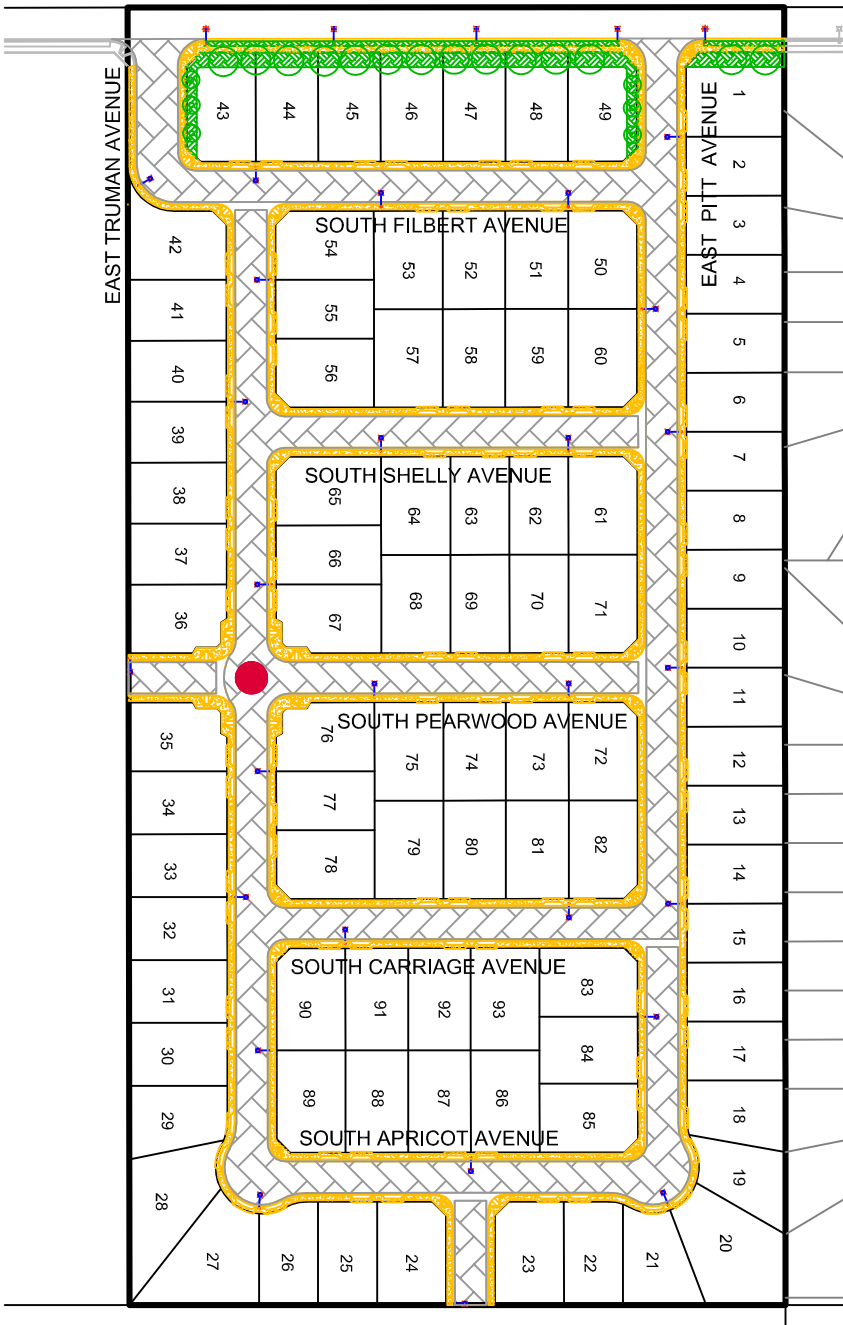

INTERIOR PAVEMENT:

TOTAL AREA = 148,945 SF

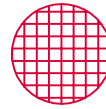

TRAFFIC CIRCLE

NON-PAVEMENT = 284 SF

IN ROAD-PAVEMENT = 490 SF

CURB = 63 LF

STANDARD STREET LIGHTS:

TOTAL = 31 EACH (2 ARE SAFETY LIGHTS)