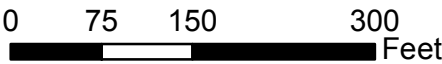
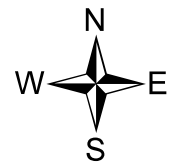
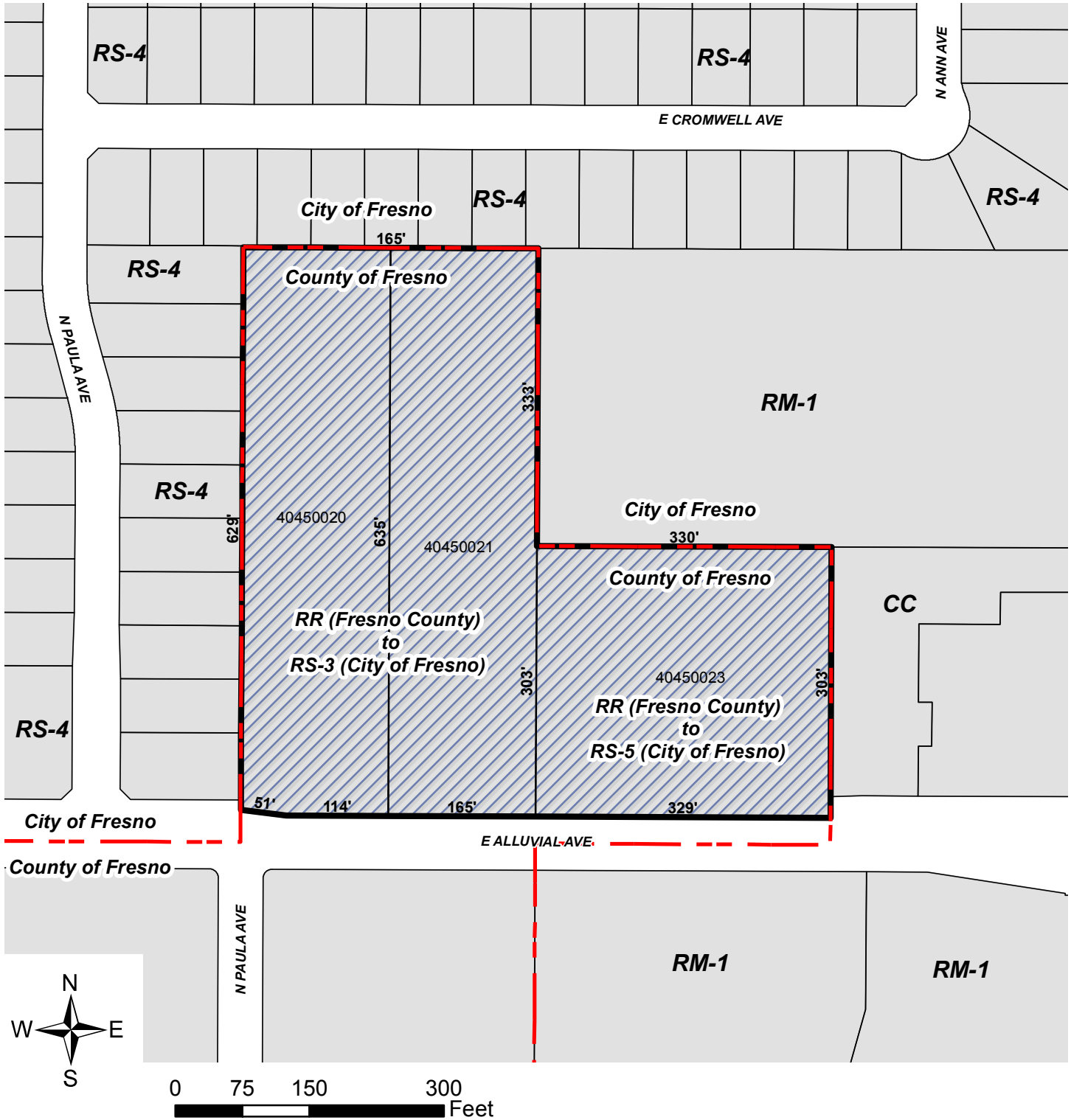

EXHIBIT A



R-17-008
APN: 404-500-20, 21, and 23 (7.10 Acres)
2792 E Alluvial Avenue

- City Limits
- From Fresno County RR (Rural Residential Neighborhood Beautification) zone district to the City of Fresno RS-3 - Residential Single-Family, Low Density and RS-5 (Residential Single Family, Medium Density) zone districts.