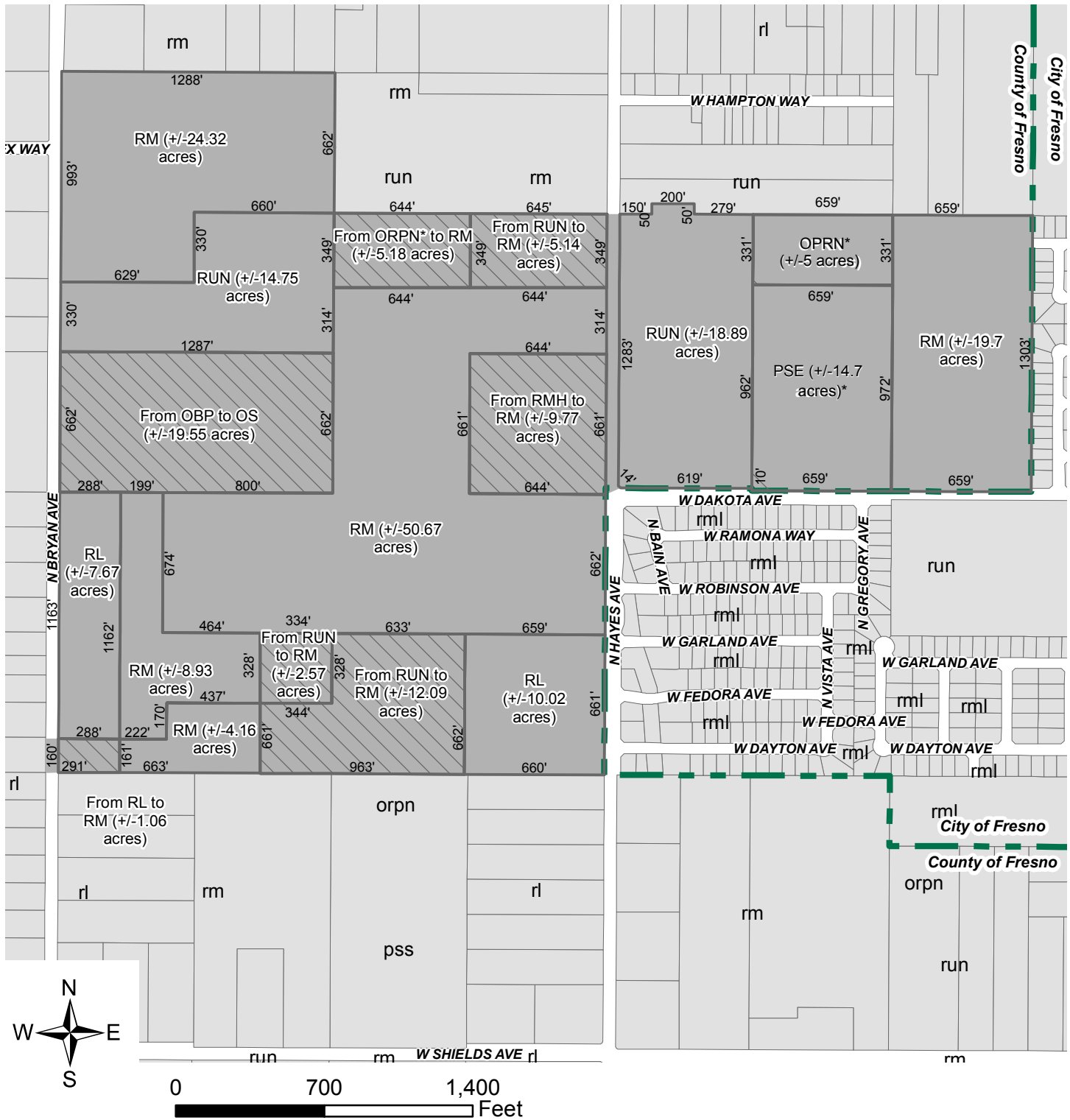





Exhibit E

EXHIBIT E -PROPOSED LAND USE



P19-02237

Corner of N Hayes Avenue and W Dakota Avenue
 APNS: 511-011-20,21,22,24,25,26,27,28,29,30,31,34, 512-050-08,09,64,82T,91,92,512-141-09,10,11,12,13, 15,16,17,18,19,26,27,43,44

-  Proposes to Amend Approximately 54.3 Acres of Rural Residential (County) Property.
-  Proposed area to be Annexed to the City of Fresno - 235.9 Acres
-  City Limits

* Has a dual land use designation of Urban Neighborhood.