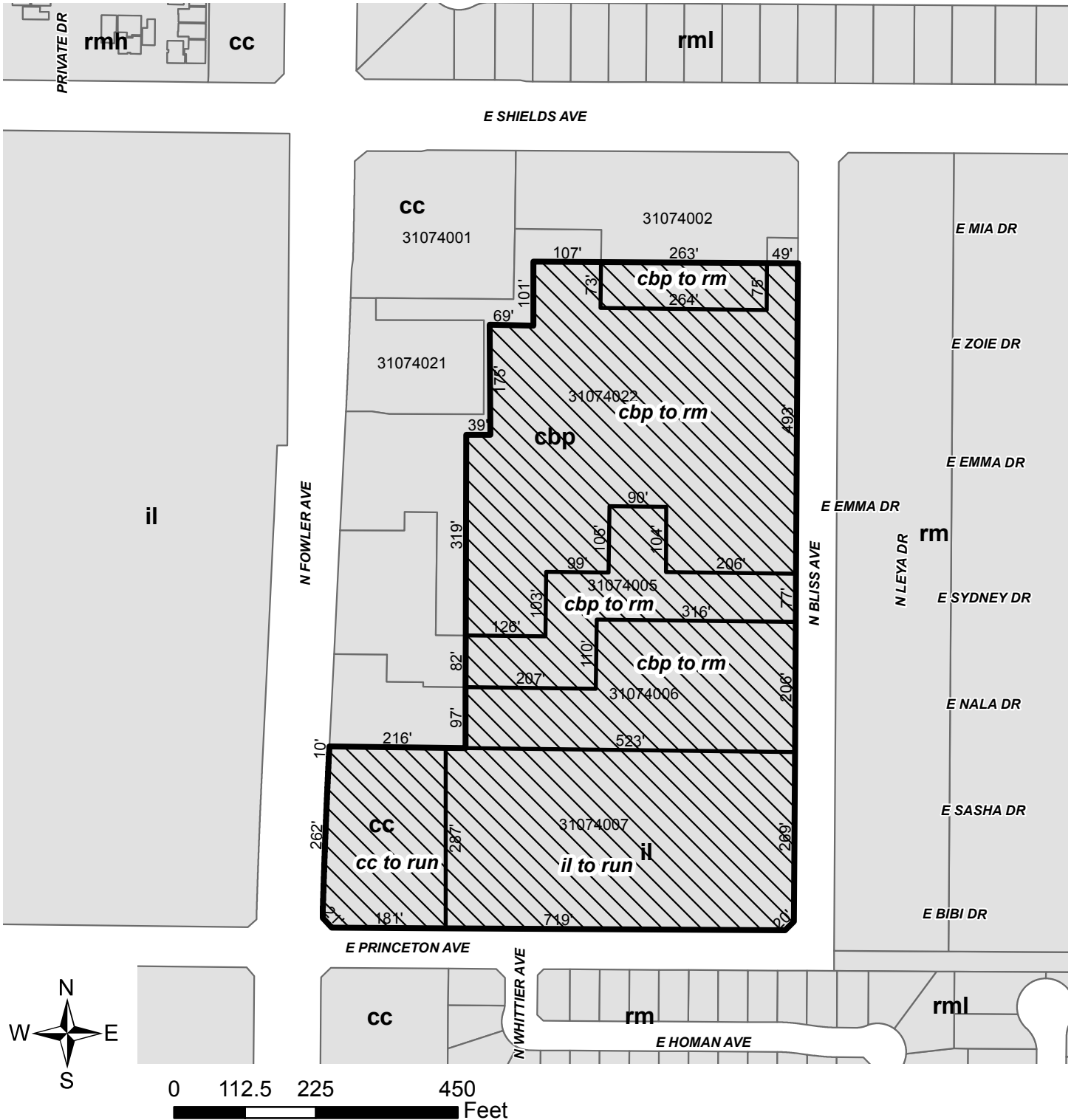

Exhibit B - Planned Land Use



A-17-010

APN: 310-740-07 Portions of 05, 06, 22 and 02

2770 N Fowler Ave



From Commercial-Community, Light Industrial and Business Park to Residential Multi-Family, Urban Neighborhood and Residential Single-Family Medium Density - 13.76 Acres

Exhibit B - Zoning

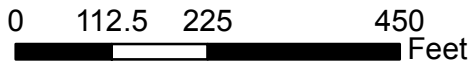
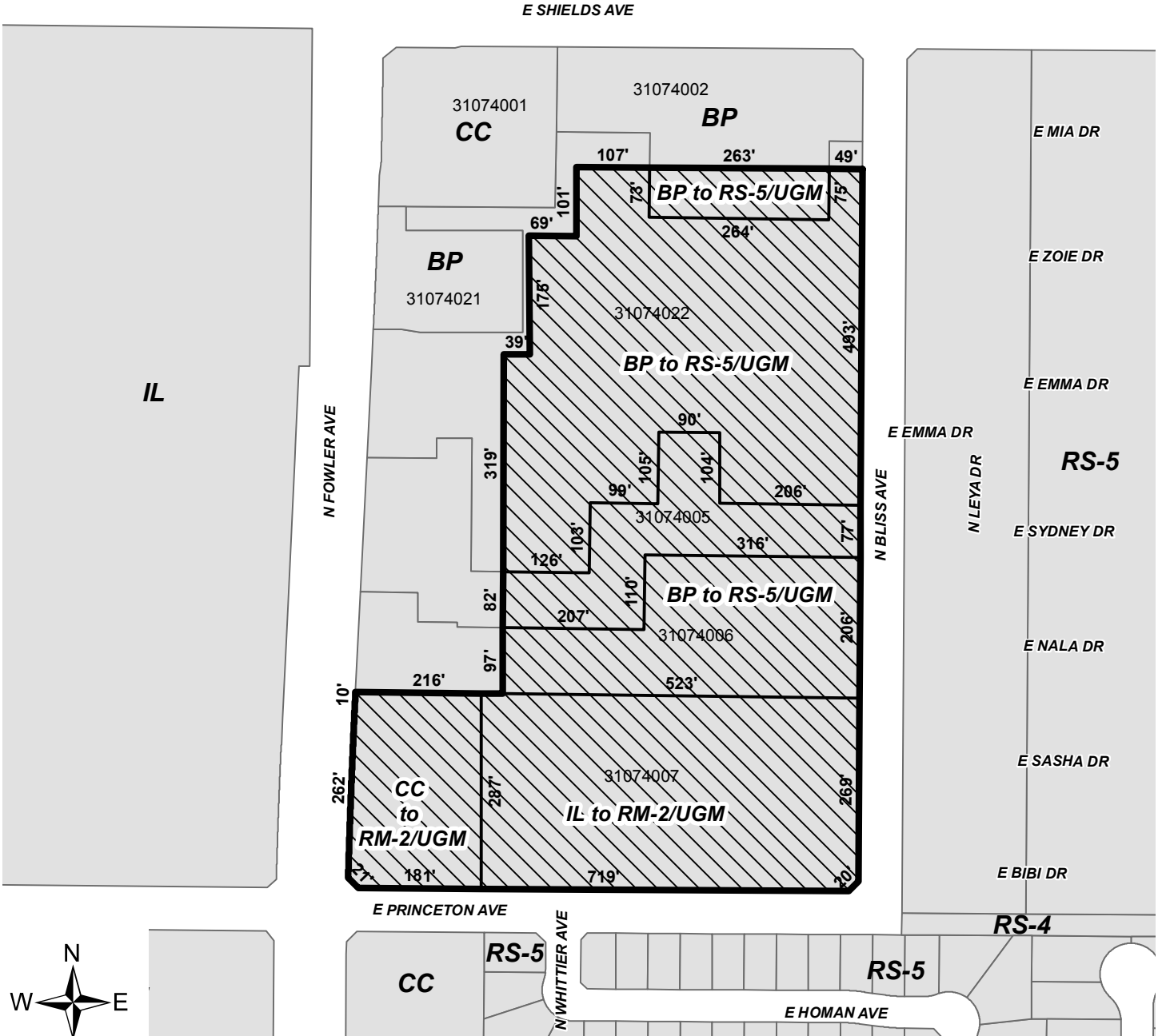
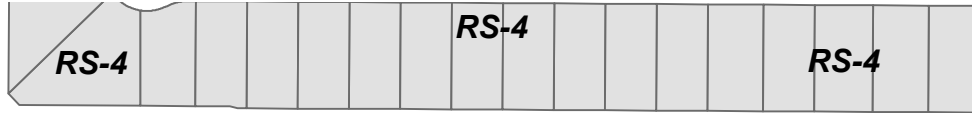

R-17-014
APN: 310-740-07 Portions of 05, 06, 22 and 02
2770 N Fowler Ave

 Proposes to amend the Official Zone Map to reclassify 4.87 acres of the property from CC+IL (Commercial-Community, Light Industrial) to RM-2/UGM (Residential Multi-Family, Urban Neighborhood/Urban Growth Management) and 8.89 acres of the property from BP (Business Park) to RS-5/UGM (Residential Single-Family Medium Density/Urban Growth Management).