

**SIGNING AND STRIPING GENERAL NOTES:**

- WORK SHALL BE DONE IN ACCORDANCE WITH THE 2010 EDITION OF THE STATE OF CALIFORNIA DEPARTMENT OF TRANSPORTATION STANDARD PLANS AND SPECIFICATIONS, SIGN SPECIFICATION SHEETS, THE 2014 CALIFORNIA MANUAL ON UNIFORM TRAFFIC CONTROL DEVICES (2014 CALIFORNIA MUTCD), THE LATEST EDITION OF THE CITY OF FRESNO STANDARD SPECIFICATIONS AND DRAWINGS, AND THE SPECIAL PROVISIONS.
- THESE PLANS ARE ACCURATE FOR SIGNING AND STRIPING ONLY.
- ALL SIGNS SHALL BE 3M-3930HIP TYPE III & IV SERIES REFLECTIVE SHEETING AND BE COVERED WITH 1160A PREMIUM OVERLAY ANTI-GRAFFITI FILM OR AVERY DENNISON T6500 SERIES REFLECTIVE SHEETING AND SHALL BE COVERED WITH AVERY DENNISON 011000ANTI-GRAFFITI OVERLAY FILM
- ALL SALVAGED MATERIALS SHALL BE DELIVERED TO THE CITY OF FRESNO CORPORATION YARD AT 2101 G STREET, FRESNO. THE CONTRACTOR SHALL NOTIFY THE CITY SIGN SHOP, (559) 621-1492, AT LEAST TWO WORKING DAYS PRIOR TO DELIVERY.
- EXISTING STRIPING, SYMBOLS, LEGENDS, AND MARKINGS TO BE REMOVED SHALL BE DONE BY WET SANDBLASTING. DRY SANDBLASTING MAY BE USED IN SELECTED AREAS ONLY WITH THE PERMISSION OF THE CITY TRAFFIC ENGINEER AND WITH THE APPROVAL OF THE AIR POLLUTION CONTROL DISTRICT. ALTERNATE METHODS OF REMOVAL REQUIRE APPROVAL OF THE CITY TRAFFIC ENGINEER. AFTER REMOVAL, SLURRY SEAL SHALL BE APPLIED TO THE AFFECTED AREAS.
- WITH THE EXCEPTION OF BIKE LANE SYMBOLS, ALL STRIPING SHALL BE THERMOPLASTIC.
- ALL CROSSWALKS SHALL BE 12 FEET WIDE, OUTSIDE EDGE TO OUTSIDE EDGE.
- THE CONTRACTOR SHALL FURNISH AND INSTALL NEW TYPE K-1 (CA) MARKERS ON ALL MEDIAN ISLAND NOSES, UNLESS OTHERWISE NOTED ON THE PLAN.
- THE CONTRACTOR SHALL INSTALL DETAIL 26 (RETRO-REFLECTIVE PAVEMENT MARKERS) ALONG ALL RAISED MEDIANS, AS PER 2014 CALIFORNIA MUTCD.
- SIGNS SHALL BE INSTALLED PER CITY STANDARD DRAWING P-88, UNLESS OTHERWISE NOTED ON THE PLANS.
- ALL R28(S)(CA) SIGNS SHALL BE "TOW-AWAY/NO STOPPING ANY TIME" SIGNS PER CITY STANDARD DRAWING P-91 AND SHALL BE INSTALLED AT A 45° ANGLE FACING ONCOMING TRAFFIC.
- CONTRACTOR TO COMPLY WITH SPECIFICATIONS FOR TESTING AND REMOVAL OF STRIPING FOUND TO CONTAIN LEAD.
- TURN ARROWS TO BE PLACED 25' FROM THE END OR BEGINNING OF ADJACENT LANE STRIPING DETAIL.
- MOUNT SIGNS ON STREET LIGHTS IF WITHIN 20'.

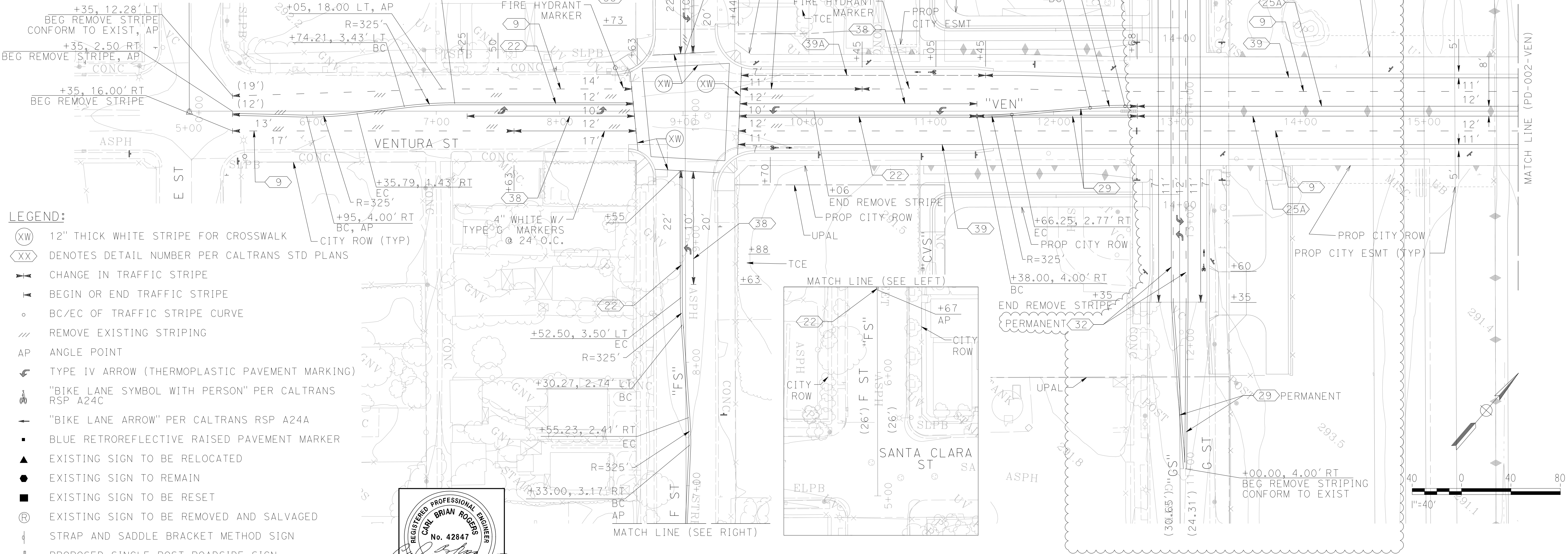

- LEGEND:**
- (XW) 12" THICK WHITE STRIPE FOR CROSSWALK
  - (XX) DENOTES DETAIL NUMBER PER CALTRANS STD PLANS
  - CHANGE IN TRAFFIC STRIPE
  - BEGIN OR END TRAFFIC STRIPE
  - BC/EC OF TRAFFIC STRIPE CURVE
  - /// REMOVE EXISTING STRIPING
  - AP ANGLE POINT
  - ↖ TYPE IV ARROW (THERMOPLASTIC PAVEMENT MARKING)
  - 🚲 "BIKE LANE SYMBOL WITH PERSON" PER CALTRANS RSP A24C
  - ➔ "BIKE LANE ARROW" PER CALTRANS RSP A24A
  - BLUE RETROREFLECTIVE RAISED PAVEMENT MARKER
  - ▲ EXISTING SIGN TO BE RELOCATED
  - EXISTING SIGN TO REMAIN
  - EXISTING SIGN TO BE RESET
  - Ⓜ EXISTING SIGN TO BE REMOVED AND SALVAGED
  - STRAP AND SADDLE BRACKET METHOD SIGN
  - PROPOSED SINGLE POST ROADSIDE SIGN
  - \* INSTALL ROADSIDE SIGN
  - \*\* INSTALL SIGN ON STREET LIGHT POLE
  - SNS STREET NAME SIGNS



REV	DATE	BY	CHK	APP	DESCRIPTION
2	12/5/22	CR	MD	CR	FCN 441
1	02/17/2020	VH	RB	JM	READY FOR CONSTRUCTION - CITY COMMENTS
0	7/6/18	NP	AM	JM	READY FOR CONSTRUCTION

DESIGNED BY: D. KACHI  
 DRAWN BY: D. KACHI  
 CHECKED BY: T. TAKAHASHI  
 IN CHARGE: S. BATES  
 DATE: 7/6/18

**Tutor Perini**  
**ZACHRY**  
**PARSONS**  
 A joint venture

CONSULTANT  
 TP2P, A Joint Venture  
 1401 Fulton St.  
 Suite 400  
 Fresno, California 93721  
 Tel. (559) 385-7025

**CITY OF FRESNO** DEPARTMENT OF PUBLIC WORKS  
 CALIFORNIA HIGH-SPEED TRAIN PROJECT  
 FINAL FACILITY PLANS  
 VENTURA STREET GRADE SEPARATION  
 PAVEMENT DELINEATION PLANS  
 SHEET 1 OF 4

REVIEWED: \_\_\_\_\_ CITY ENG. \_\_\_\_\_  
 OFFICE ENG. \_\_\_\_\_  
 DR. BY: \_\_\_\_\_ SHEET NO. 28  
 CH. BY: \_\_\_\_\_ OF 18 SHEETS  
 DATE: \_\_\_\_\_  
 SCALE: 1"=40' PD-001-VEN

3/26/2025 9:30:21 AM CAHSRP\_Hoif.tbl CHSR\_PDF\_full\_block.plt c:\pw\_working\california\persons\_p009263\arms12455\GP1-CY-PD001-VEN.dgn

**NOTES:**

1. PARKING STALLS 23' IN LENGTH EXCEPT FOR STALLS AT ENDS.
2. SEE COF STD W-5 FOR TYPICAL PLACEMENT OF FIRE HYDRANT MARKERS.

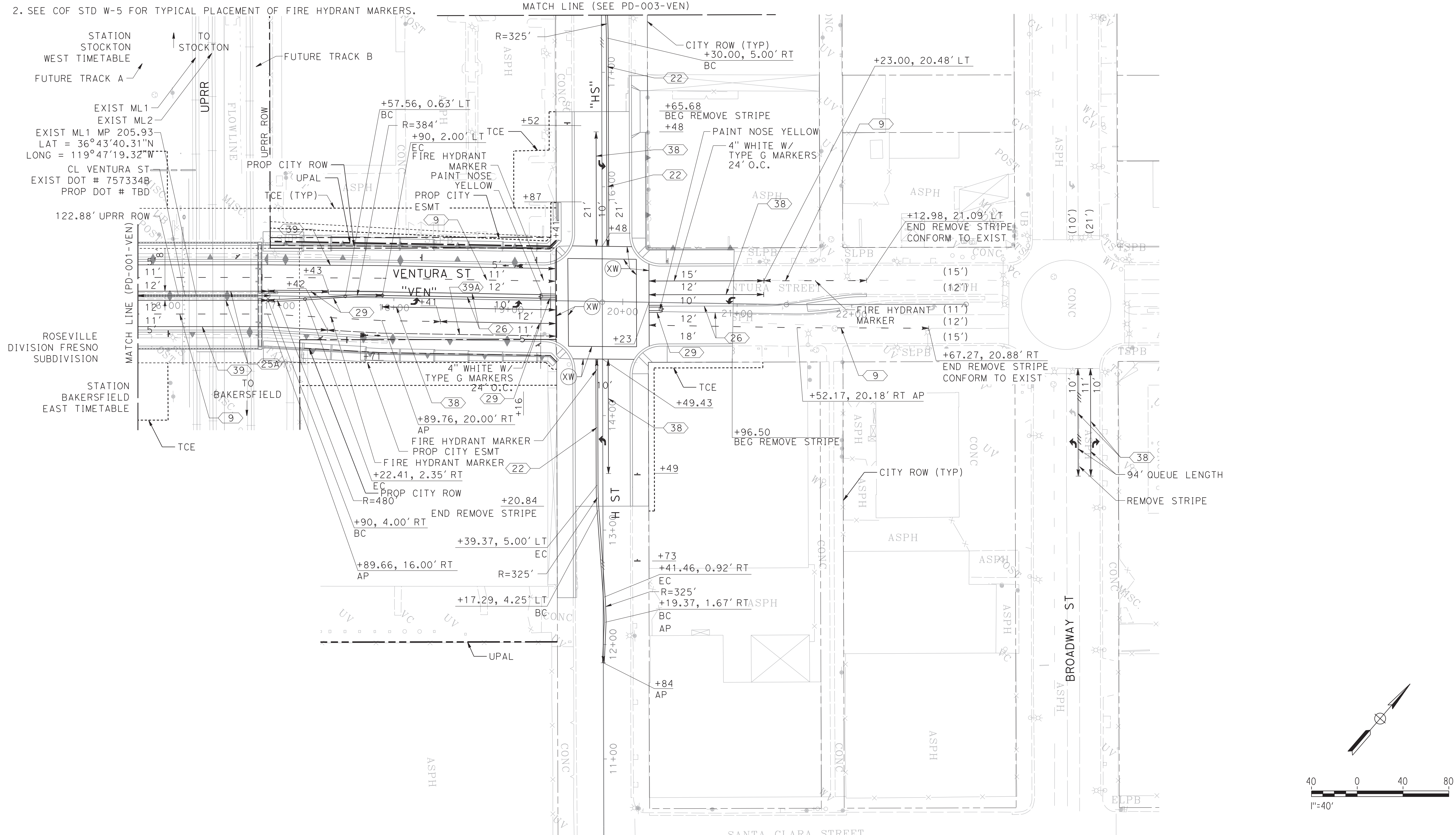

CHSR\_PDF\_full\_block.plt c:\pw\_working\california\parsons\_p008899c\dms12455\GP1-CY-PD002-VEN.dgn  
 2/20/2020 6:04:59 PM CHSTP:ibi



REV	DATE	BY	CHK	APP	DESCRIPTION
1	2/17/2020	RB	AM	JM	READY FOR CONSTRUCTION - COF COMMENTS
0	7/6/18	NP	AM	JM	READY FOR CONSTRUCTION

DESIGNED BY  
D. KACHI  
 DRAWN BY  
D. KACHI  
 CHECKED BY  
T. TAKAHASHI  
 IN CHARGE  
S. BATES  
 DATE  
7/6/18

**Tutor Perini**  
**ZACHRY**  
**PARSONS**  
 A joint venture

CONSULTANT  
 TP2P, A Joint Venture  
 1401 Fulton St.  
 Suite 400  
 Fresno, California 93721  
 Tel. (559) 385-7025

**CITY OF FRESNO** DEPARTMENT OF PUBLIC WORKS  
 CALIFORNIA HIGH-SPEED TRAIN PROJECT  
 FINAL FACILITY PLANS  
 VENTURA STREET GRADE SEPARATION  
 PAVEMENT DELINEATION PLANS  
 SHEET 2 OF 4

REVIEWED: 12/28/2020  
 OFFICE ENG. 01/04/2021  
 DR. BY: \_\_\_\_\_ SHEET NO. 29  
 CH. BY: \_\_\_\_\_ OF 118 SHEETS  
 DATE: \_\_\_\_\_  
 SCALE: 1"=40' PD-002-VEN

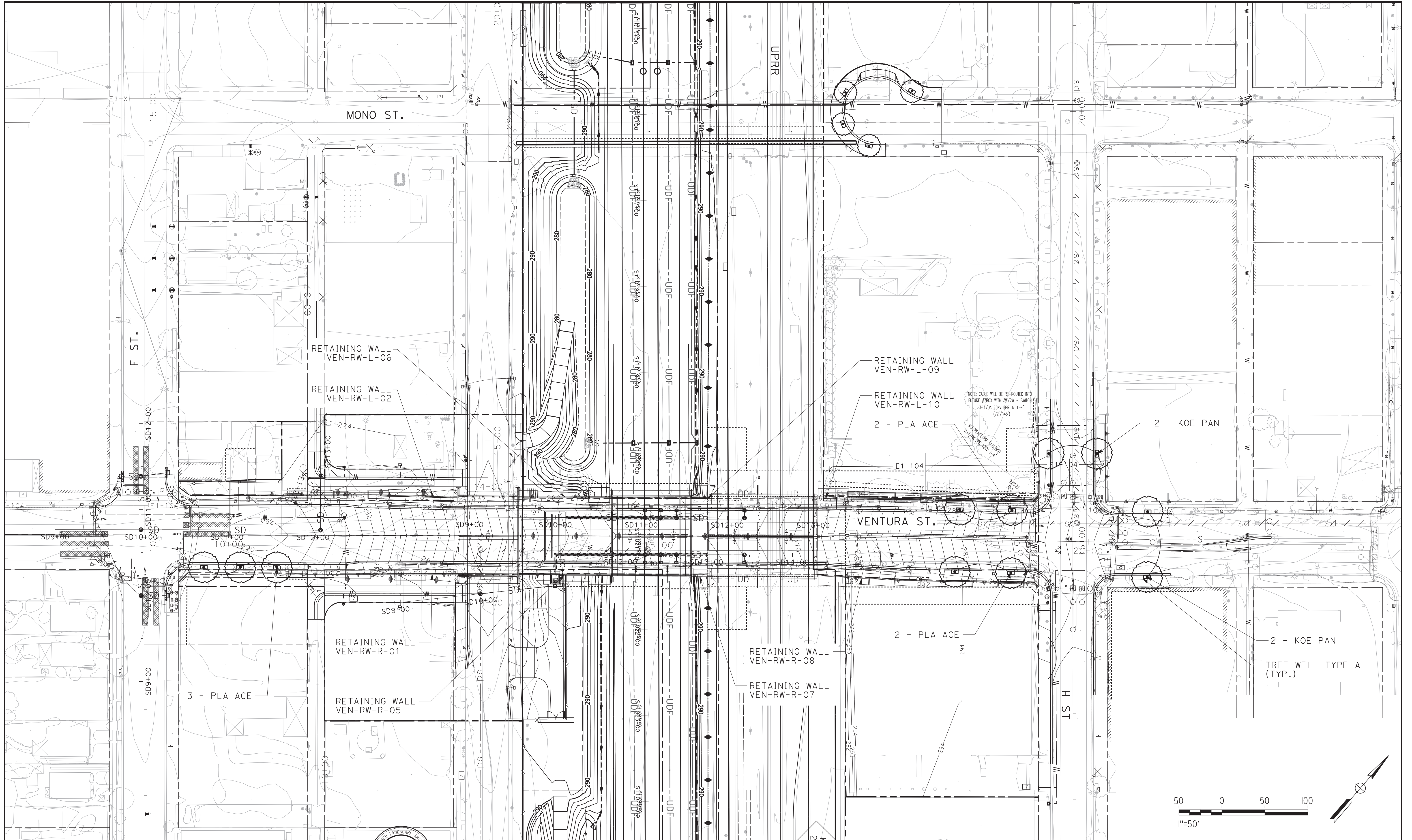

pw: \\t\p102\pwin101\parsons.com\california\state\documents\CHSTP\_CP1\_N05 - Design\User Files\PARSONS\Jon.Christiansen\LANDSCAPING\SHEETS\KeyMap.dgn  
 5/20/2020 1:32:05 PM CHSR\_PDF\_full\_block.plt c:\pw\_working\california\37513\00105008\Sheet25.dgn  
 CHSTP.tbl

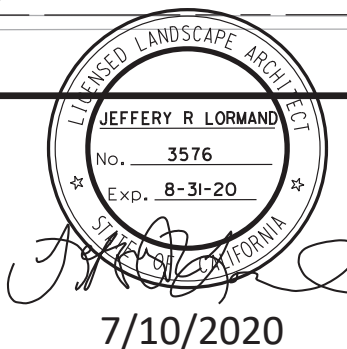

7/10/2020

REV	DATE	BY	CHK	APP	DESCRIPTION
I	02/17/20	JM	PN	JL	READY FOR CONSTRUCTION - CITY COMMENTS
O	07/06/18	JM	PN	JL	READY FOR CONSTRUCTION

DESIGNED BY  
 S. ROZENDAAL  
 DRAWN BY  
 J. McDONALD  
 CHECKED BY  
 P. NKOLAI  
 IN CHARGE  
 J. LORMAND  
 DATE  
 07/06/18



CONSULTANT  
 TP2P: A Joint Venture  
 1401 Fulton St.  
 Suite 400  
 Fresno, California 93721  
 Tel. (559) 385-7025

PW FILE NO.  
 PROJ. ID.  
 FUND NO.  
 ORG. NO.

**CITY OF FRESNO** DEPARTMENT OF PUBLIC WORKS  
 CALIFORNIA HIGH-SPEED TRAIN PROJECT  
 FINAL FACILITY PLANS  
 VENTURA PLANTING PLAN 1 OF 1

REVIEWED: 12/29/2020 01/04/2021  
 OFFICE ENG. QTY ENG.  
 DR. BY: SHEET NO. 110  
 CH. BY: OF 118 SHEETS  
 DATE SCALE LS-002-VEN

