



ADOPTION PROPOSAL AND AGREEMENT
For Park and Trail Adoptions

Date: 1-19-2018

Adopt-A-Park Participant/Group): Southeast Fresno Regional Park and Soccer Complex Authority

Group Contact Person: Jose Leon-Barraza

Mailing Address: 5288 E Heaton Ave. City: Fresno State: CA Zip:

Phone: Cell: 559-301-0695 Email: joseleonbarraza50@gmail.com

Park Interested in Adopting: 49-acre park site Location: 2155 S. Peach Ave.

Area(s) Interested in Maintaining: Northern Parcel (18 acres)

Duties (Scope of Work): Please see Attached.

Work Schedule: Total Hours:

TERMS AND CONDITIONS

1. **TERM:** Subject to the City's right to terminate, this agreement shall be in full effect for **one year** beginning Feb. 15, 2018.
2. **CONDITIONS:**
 - a) The Adopt-A-Park participant/group shall develop and follow a regular schedule of maintenance of the property as agreed upon by the City Fresno and report any park hazards to City staff.
 - b) The Adopt-A-Park contact person shall report all hours volunteered to the Adopt-A-Park Coordinator.
 - c) Each individual participant must complete and sign the City of Fresno's Volunteer Service Application and the Waiver and Indemnity Agreement for Volunteer Service, prior to participating in the Adopt-A-Park Program.
 - d) The City of Fresno may photograph or videotape the events or activity in which the participant is participating for the purpose of promoting the City of Fresno and its services/programs, with the following understanding, "that no compensation of any kind will be paid to the participant".
3. **ACCESS:** Volunteers are allowed access to City property for the purpose of carrying out the terms of this agreement.

The City of Fresno reserves the right to terminate this agreement at any time.

ADOPT-A-PARK PARTICIPANT

CITY OF FRESNO

Jose Leon-Barraza
Signature

Signature of Adopt-A-Park Coordinator

For office use only: Approved/Denied (Circle) | Date: _____ | Training Date: _____ | Date Started: _____
Explanation for Denial: _____

ADDENDUM TO ADOPT A PARK APPLICATION-Jan. 19, 2018

APPLICANT: Southeast Fresno Regional Park and Soccer Complex Joint Powers Authority (JPA).

TARGETED LOCATION: 2155 S. PEACH AVENUE, FRESNO, CA 93727.

Work to be performed under the Adopt-A-Park Program will initially concentrate on the 18 acres located on the northern segment of the site as outlined in Exhibit A. Tasks to be performed by the JPA will begin February 1, 2018 and will continue through June 30, 2019, with all work coordinated with the City of Fresno PARCS staff. During this period, City of Fresno will continue to fund existing property related expenses, including but not limited to, insurance coverage and all applicable utilities.

General Site Clean Up.

The current conditions at this site includes dry grass, weeds, trash and other debris that could cause a fire on this site which could potentially damage existing structures and/or adjacent neighboring homes. The JPA will regularly schedule monthly clean up events within the boundaries of the 49-acre site as well as adjacent streets. The JPA will be responsible for the removal of tall grass, weeds, trash and debris to ensure mitigate potential fire hazard conditions are removed from this park site.

Beginning, on February 17, 2018 through the end of March, 2018, JPA will conduct weekly JPA clean up events at the site every Saturday between the hours of 10:00 am to 2:00 pm. The JPA will conduct, at a

minimum, subsequent clean up events every month over the remaining term of this Agreement. The JPA may facilitate additional clean up events in order to ensure that the parcel(s) are clean, beautiful and in safe condition.

2. Pruning of Existing Shrubs and Trees

This work will be performed by a more specialized team of volunteers with pruning experience. This work will take place the same days the clean-up events are scheduled. Volunteers without pruning experience will be provided training before they can participate in any pruning work.

3. Tree Planting.

Planting of new shrubs, 120 trees and 60,000 square feet of turf as well as the installation of a new irrigation and supporting drainage systems; if so warranted. The City will provide technical support; including but not limited to, review and approval of the type of materials and plantings that will occur on the site as well as the proposed irrigation plans and installation.

Joe Lem-Bauer Jan 19, 2018

EXHIBIT A-1

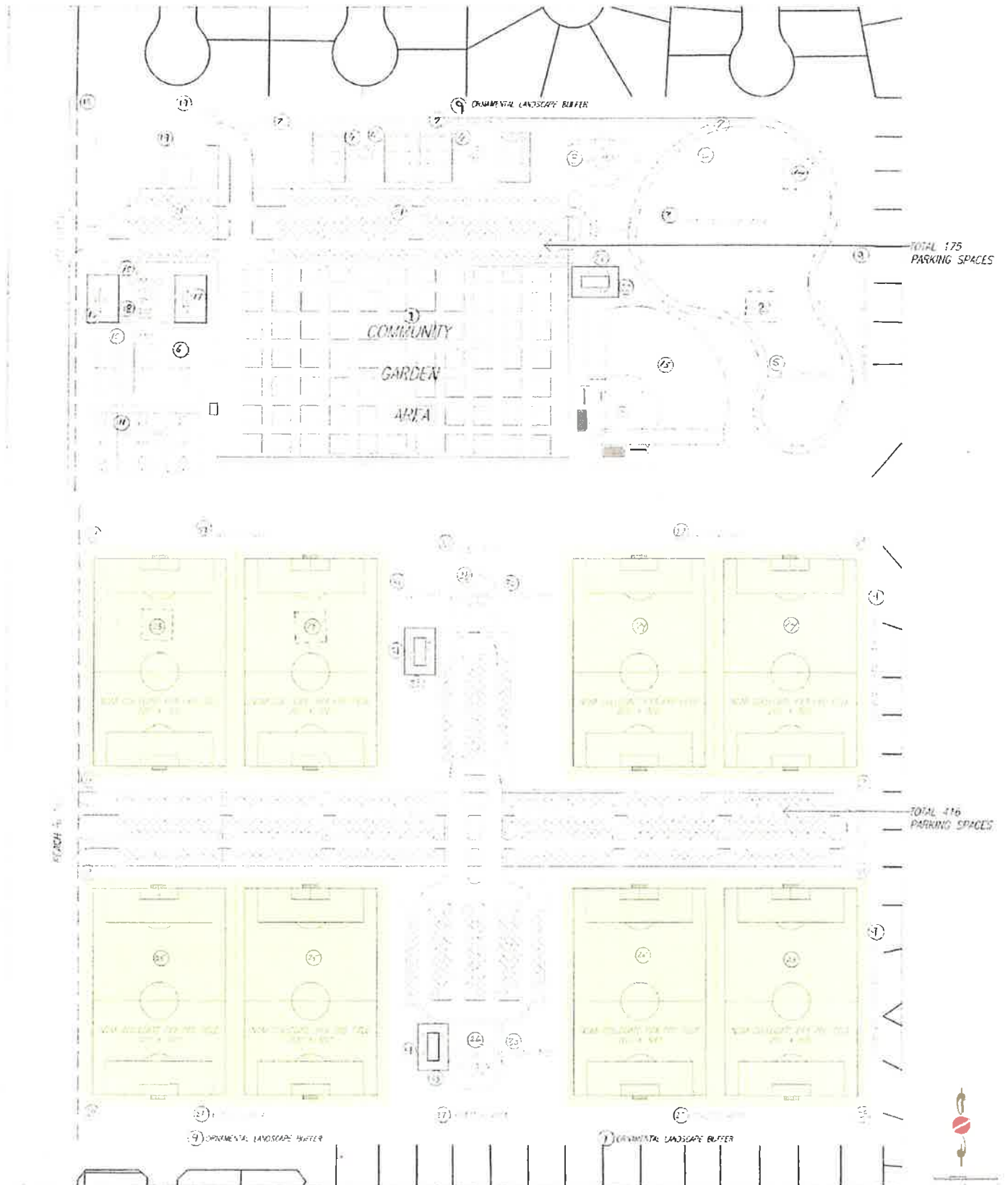

THE SOUTH SIDE PLAZA, TRIANO PARK AND SOCCER SPORTS COMPLEX

PROPOSED PARK AND SOCCER COMPLEX:

I) A REGIONAL PARK

on the northern 19-acre parcel will include:

- 1) An existing community garden
- 2) A veterans memorial garden
- 3) An open space playground area
- 4) Picnic areas
- 5) A woodland component
- 6) A Futsal Court
- 7) All-purpose trails
- 8) Children playground equipment areas
- 9) Landscaped area along property lines
- 10) Tennis courts
- 11) Basketball courts
- 12) Volleyball/Katar courts
- 13) Softball diamond
- 14) A dog park
- 15) A community center complex
- 16) A multi-purpose hall
- 17) Multi-purpose rooms
- 18) Outside Activity Courtyard
- 19) Office space for volunteers, park staff & maintenance shop
- 20) A concession stand
- 21) Parking
- 22) Restrooms

II) A SOCCER COMPLEX

on the southern 30-acre parcel will include:

- 23) Permanent outdoor Futsal Court
- 24) Two soccer fields with synthetic turf,
- 25) Five soccer fields ^{with natural grass or synthetic turf}
- 26) Children playground equipment areas
- 27) Practice Areas
- 28) An indoor Futsal facility,
- 29) All-purpose trails
- 30) Picnic areas
- 31) A concession stand
- 32) Parking
- 33) Restrooms

**Please refer to plan
on the right** →