

# **PLUMBING NOTES:**

1. ALL WATER CLOSETS SHALL NOT EXCEED 1.28 GALLONS PER FLUSH.
2. SINGLE SHOWER HEADS SHALL NOT EXCEED 2.0 GALLONS PER MINUTE AT 80 PSI AND MULTIPLE SHOWER HEADS SERVING ONE SHOWER SHALL HAVE A COMBINED RATE NOT TO EXCEED 2.0 GALLONS PER MINUTE AT 80 PSI.
3. LAVATORY FAUCETS SHALL HAVE A MINIMUM FLOW RATE OF 0.8 GALLONS PER MINUTE AT 20 PSI AND A MAXIMUM OF 2.0 GALLONS AT 80 PSI.
4. KITCHEN FAUCETS SHALL HAVE A MINIMUM FLOW RATE NOT TO EXCEED 1.8 GALLONS PER MINUTE AT 60 PSI.
5. BATHTUBS AND WHIRLPOOL BATHTUBS SHALL BE LIMITED TO 120°F BY A DEVICE THAT CONFORMS TO ASSE 1070 OR CSA B125.3 (CPC SECTION 409.4). THE WATER HEATER THERMOSTAT SHALL NOT BE CONSIDERED AS A TEMPERATURE CONTROL DEVICE.
6. BIDETS SHALL BE LIMITED TO 110°F BY A DEVICE THAT CONFORMS TO ASSE 1070 OR CSA B125.3 (CPC SECTION 410.3). THE WATER HEATER THERMOSTAT SHALL NOT BE CONSIDERED AS A TEMPERATURE CONTROL DEVICE.
7. SHOWERS AND TUB/SHOWERS COMBINATION SHALL BE PROVIDED WITH INDIVIDUAL CONTROL VALVES OF THE PRESSURE BALANCE, THERMOSTATIC, OR COMBINATION PRESSURE BALANCE/THERMOSTATIC MIXING VALVES TYPE THAT PROVIDE SCALD AND THERMAL SHOCK PROTECTION FOR THE RATED FLOW RATE OF THE INSTALLED SHOWERHEAD. THESE VALVES SHALL BE INSTALLED AT THE POINT OF USE AND IN ACCORDANCE WITH ASSE 1016 OR ASME A112.18.1/CSA B125.1 (CPC SECTION 408.3).
8. ALL HOSE BIBBS SHALL BE EQUIPPED WITH NON-REMOVABLE BACK FLOW PREVENTERS (CPC 603.4.7).
9. ALL PLUMBING CONVEYING OR DISPENSING WATER FOR HUMAN CONSUMPTION SHALL COMPLY WITH AB 1953 FOR LEAD CONTENT.

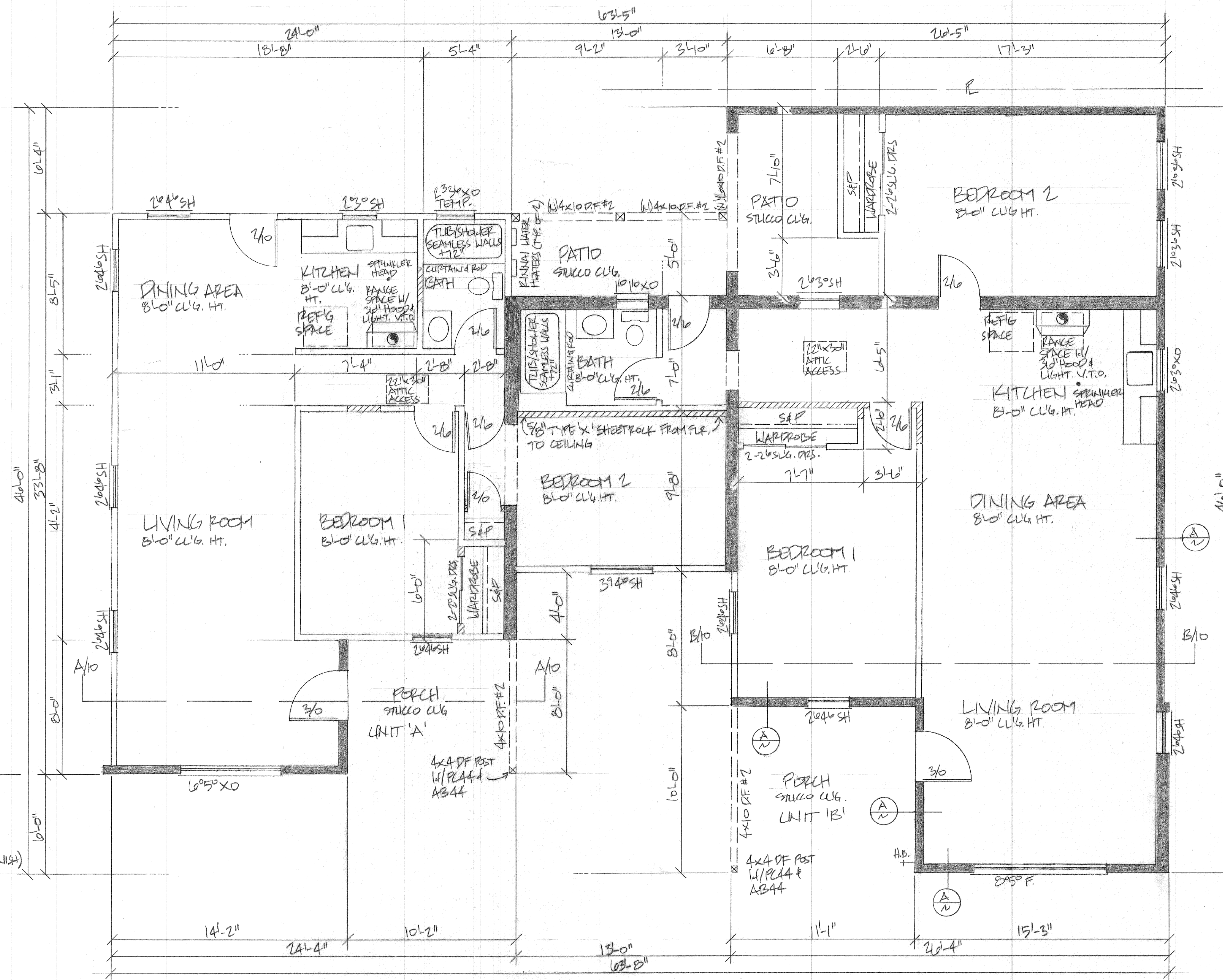
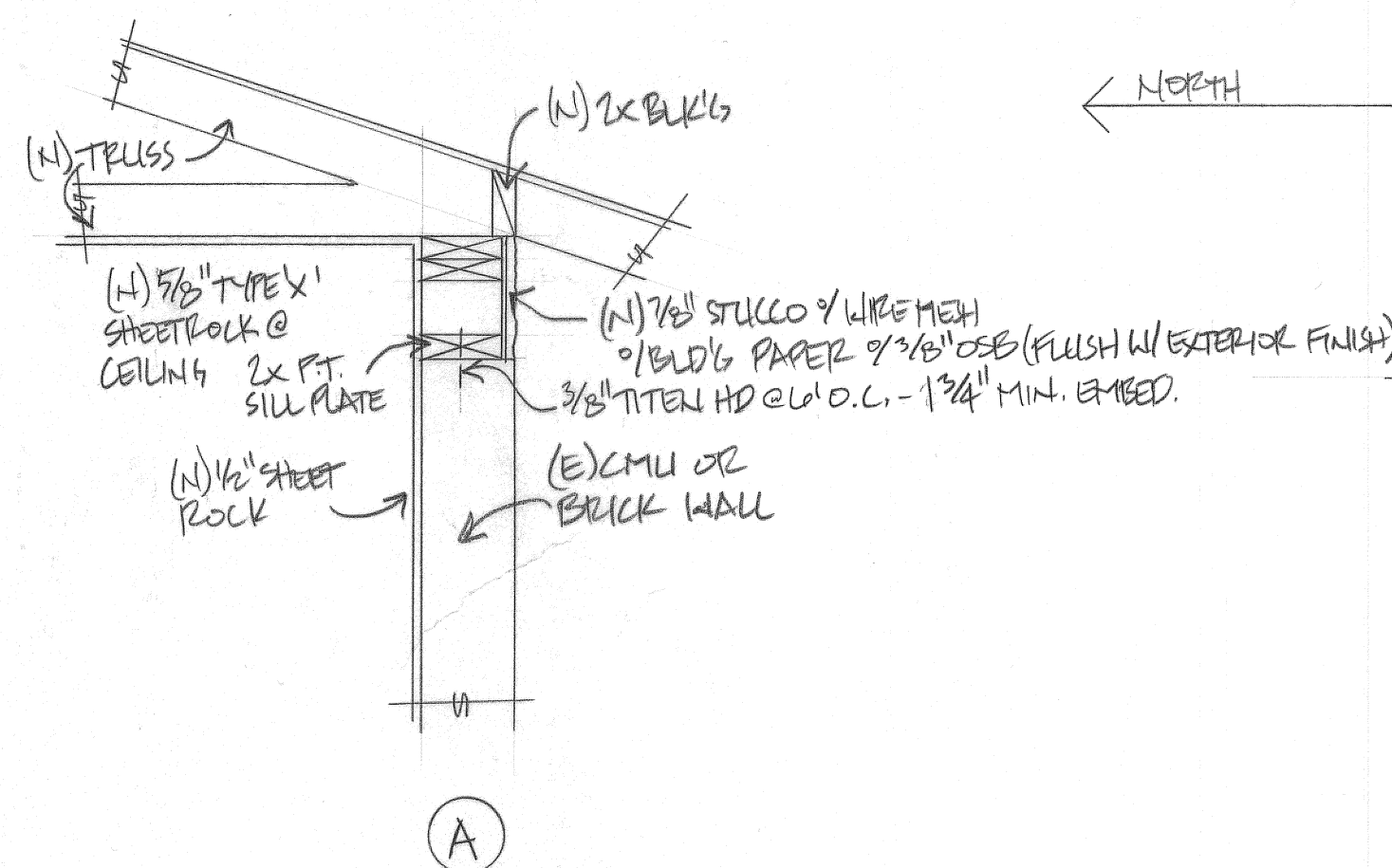

PROPOSED FLOOR PLAN - 1967 #  
SCALE: 1/4"=1'-0"

- (N) 2x4 D.F. WALL
- (E) WOOD FRAMED WALLS TO REMAIN
- (E) BRICK OR CMU WALLS TO REMAIN