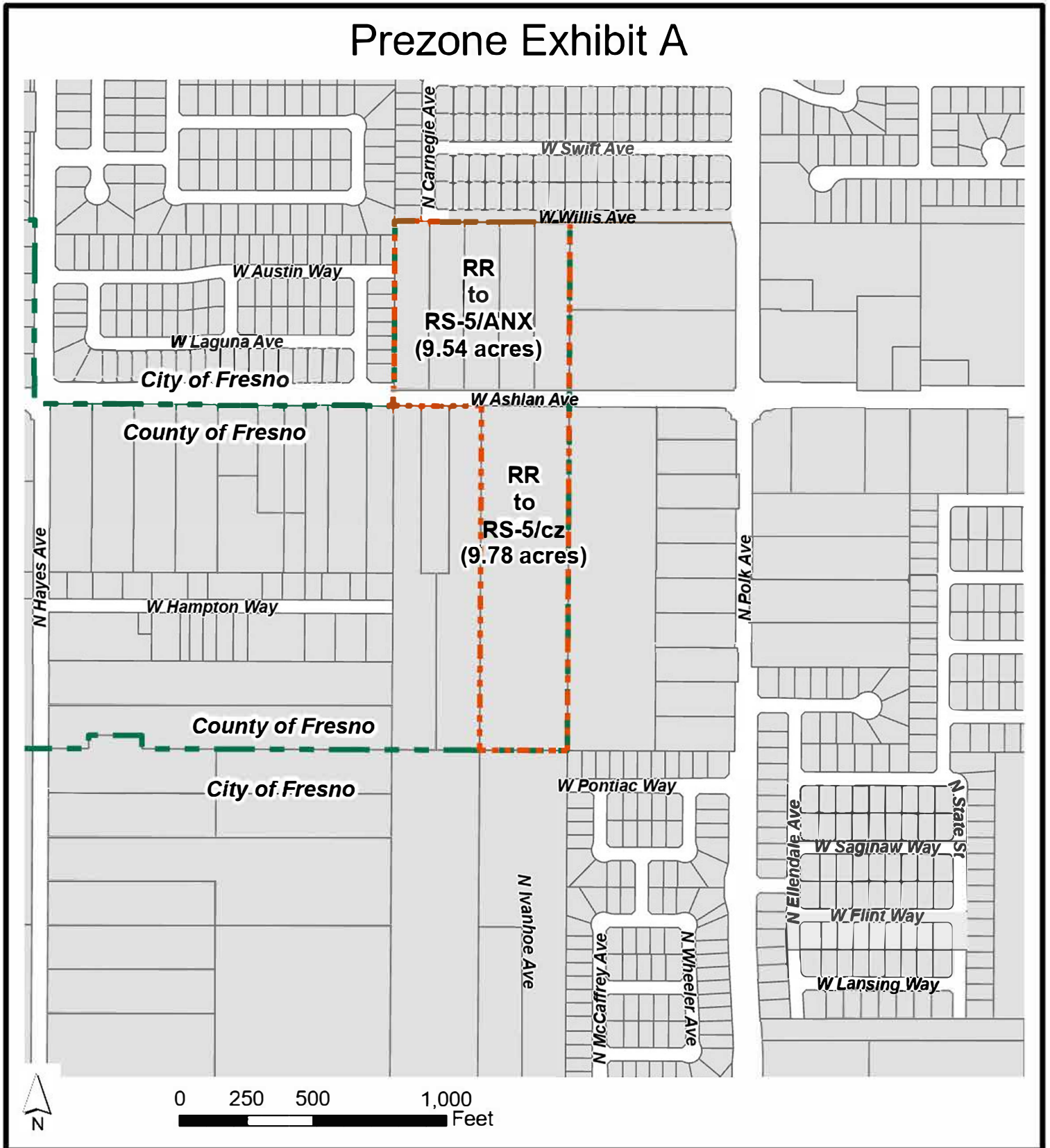

Exhibit D

Prezone Exhibit A



P22-04069

APN: 511-01-106, 510-21-001, 510-21-002, 510-21-003, 510-21-006, 510-21-007

West of the Intersection of Polk Avenue and Ashlan Avenue

 City Limits

 Proposes to pre-zone approximately 9.78 acres from RR (Rural Residential) to RS-5/cz (Residential Single-Family, Medium Density/conditions of zoning), and approximately 9.54 acres from RR (Rural Residential) to RS-5/ANX (Residential Single-Family, Medium Density/Annexed Rural Residential Transitional Overlay).